

A consulting engineering firm committed to technical excellence, DECON's services help build, maintain and improve our clients' infrastructure and facilities. Our goal is to always deliver exceptional engineering services that deliver projects on schedule, within budget, and with commitment to outstanding quality that meets our client's complete satisfaction.

Construction Engineering Services have become an important service line for DECON to support our clients during construction. We have focused on Design/Build and P3 projects for the Departments of Transportation in the states where we have been practicing during the last 20 years for a wide variety of project needs using a variety of materials and structural systems. We specialize in providing practical solutions to complex technical situations using cutting edge technology.

Each project benefits from the hands-on expertise of our most senior professionals — Fulvio E. Jaramillo, PE, F.SEI and Jorge L. Alba, PhD, PE, CFM. This assures clients and the project team of seasoned, well-rounded principals who bring innovative approaches balanced with real-world problem-solving expertise. DECON serves the following markets: transportation, heavy civil, industrial, commercial, institutional, residential and civil/site.

Founded in 2010 and headquartered in Houston, TX, DECON has offices in Atlanta, GA, and Arlington, VA, providing engineering design services using BIM/BRIM technologies based on Autodesk® and Bentley® platforms.

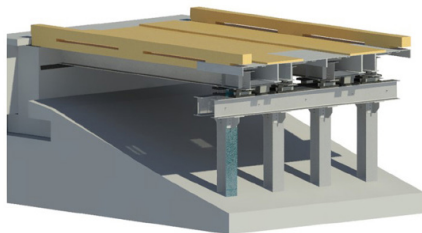

*SH-99 Grand Parkway, Houston, TX: Rail Flat Car - Provisional Construction Bridge Crossings*

## REGISTRATIONS

P.E. in Texas, Georgia, Virginia, Florida, Oklahoma, Maryland and Louisiana

NCEES PE Record

## COMPANY CODES

NAICS Code: 541330

NIGP Codes: 92500, 92513, 92517, 92519, 92528, 92537, 92538, 92541, 92542, 92545, 92546, 92548, 92549, 92556, 92570, 92588, 92593

## FEDERAL IDENTIFICATION

Cage Code: 8oM24

Duns Number: 079546386

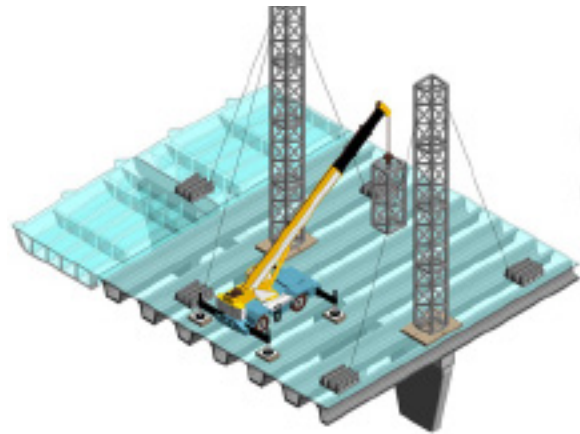

*SH-114 Signature Bridge, Irving, TX: Main truss erection plans*

## SERVICES

- Value Engineering
- Structural/Bridge Design Optimization
- Traffic Control TCP Redesign/Optimization
- Temporary and Final Roadway Drainage Optimization
- Temporary Shoring
- Bulkheads
- Bridge Demolition and Bridge Retrofit
- Temporary and Final Retaining Wall MSE, Soil Nailing, Cantilever Wall
- Tie Backs, Secant and Tangent Drilled Shafts
- Drilled Shaft and Driven Piles Misalignment correctiveness
- Corrective structural construction deficiencies
- RFI - Request for Information
- FDC - Field Design Changes
- Bridge/Structural Shop Drawings
- Bridge/Structural Erection Plans
- Form - Falsework Design

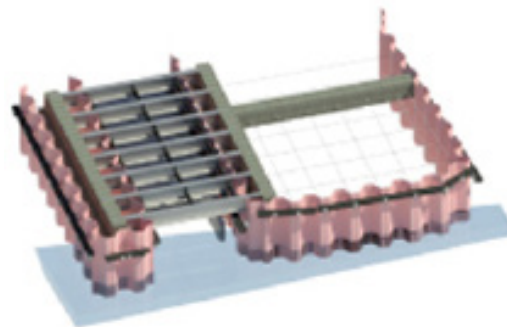

*I-35 at Brazos River, Waco, TX: Bulkhead for bridge construction*



MBE | SBE | DBE | HUB | HHF | TBPE